

NURRAGINGY RESERVE INCLUSIVE ADVENTURE PLAYSPACE

STAGE 4 - FINAL CONCEPT

1. SITE PLAN
2. GENERAL ARRANGEMENT PLAN
3. ADVENTURE WALKWAY - ABOVE GROUND
4. ADVENTURE WALKWAY - GROUND LEVEL
5. PLAY ELEMENTS
6. ART AND INTERPRETATION
8. SEATING AND FURNITURE
9. FENCING AND SIGNAGE
10. PLANTING

Vision and Theme

This playground explores the story of the Darug people of this region and the megafauna of the Pleistocene period that co-existed with them thousands of years ago. It will be an 'inclusive adventure playspace' that makes the most of the fantastic bushland setting.

KEY	
	Boundary fence 1.2m high
	2m wide concrete path (Accessible)
	Primary Entry Gate
	Secondary Entry Gate
	Existing Playground
	Existing Shelter and Seating
	Existing Toilet Facility
	Proposed Changing Places Facility



KEY	
	Boundary fence 1.2m high
	Drainage path
	Gate Entry
	Quiet spaces
	Proposed trees

SURFACES	
	2m wide concrete path (Accessible)
	Exposed aggregate concrete (Accessible)
	Stabilised decomposed granite (Accessible)
	Rubber softfall (Accessible)
	Mulch softfall
	Mulch
	Planting
	Sand

PLAY EQUIPMENT	
	Adventure walkway
	Play monster sculpture
	Water pump to sandpit
	Fossil excavation sandpit
	Raised accessible sand table
	Log balancing beams and steppers
	Nest caves
	7-Seat Swing
	Accessible trampoline
	Xylophone
	Drum

	3m A-Frame climber
	Net Seesaw
	Spinning rope climber
	Den making wigwam
	Play Bridge
	Misters

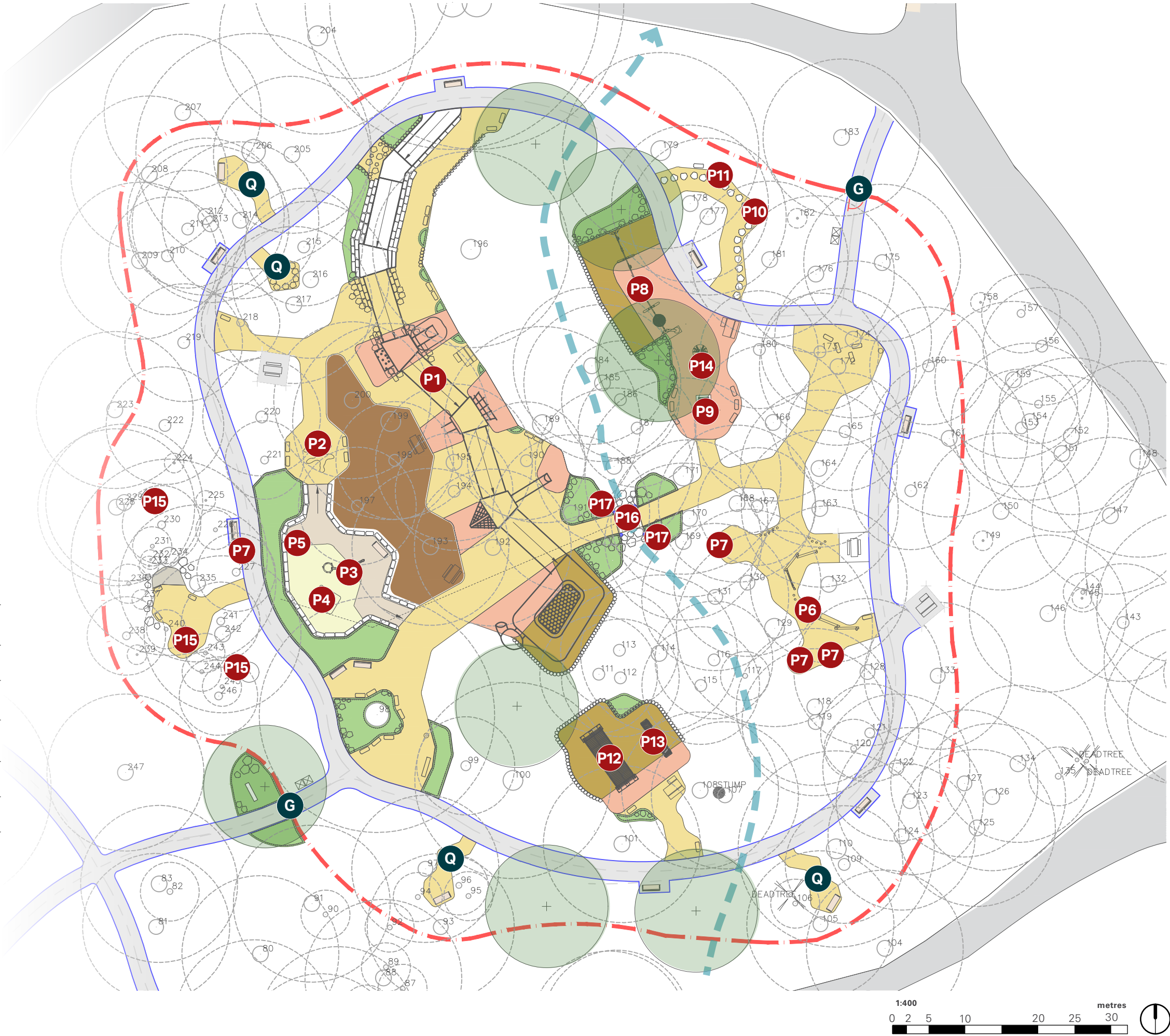

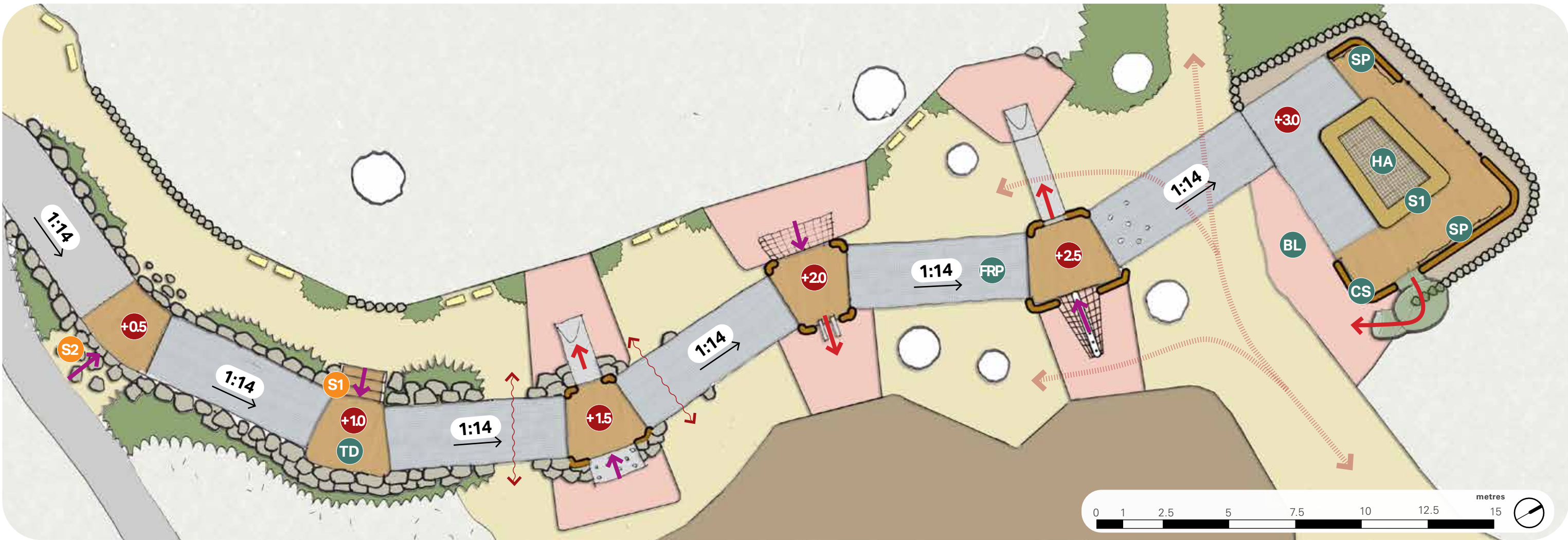

Adventure Walkway Elevation

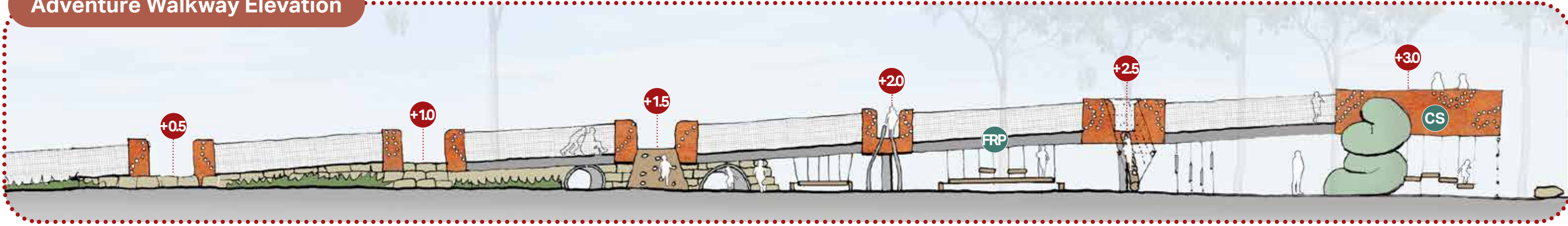





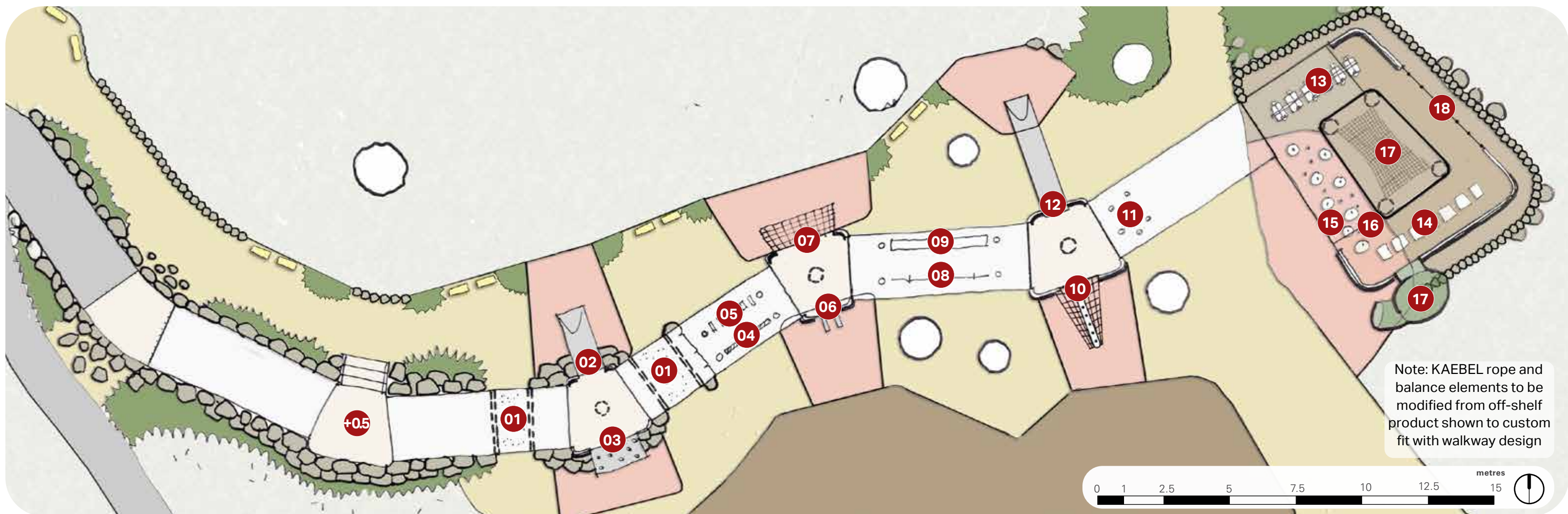



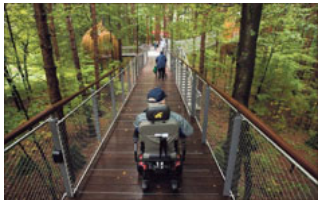





KEY

	Path clear of play elements under walkway for pedestrian access.		Walkway landings at 0.5m height increments		Rubber softfall (accessible)		FRP decking (7m ramp)		Modwood seating edge
	Play access under walkway		Stair access with handrail		Stabilised decomposed granite (accessible)		Modwood decking landings		Raised hammock netting
	Access up to walkway		Stepping stone access		Mulch softfall		Perforated Corten Steel panel		Sensory play element
	Access down from walkway				Mulch		Balance logs and steppers		

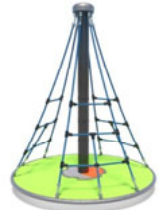

- 01 Tunnel
- 02 1.5m High Wide Slide
- 03 1.5m High Bouldering Wall
- 04 Stepper Walk 3m [CN-1015]
- 05 Burmese Balance with Timber Steps [CN-1043]
- 06 Double Wave Banister Slide [CN-1066]
- 07 Ninja Warrior Climber [CN-1062 MODIFIED]
- 08 Spreader Belt Wiggle Walk [CN-1046]
- 09 Spreader Belt Walk [CN-1040]
- 10 Inclined Log with Non-Climb Netting
- 11 Chimes [CN-1056]
- 12 2.5m Embankment Slide
- 13 HDPE Monkey Bar [CN-1054]
- 14 Membrane Mountain [CN-1055 MODIFIED HEIGHT]
- 15 Pommels [CN-1031]
- 16 Bead Crossing [CN-1041]
- 17 Quadtramp 2x Small Membrane [CN-1035 MODIFIED]
- 18 Honeycomb Scramble [CN-1020]
- 19 3m tall slide

PLAY EQUIPMENT SCHEDULE			
CODE	TYPE	MATERIAL / COLOUR / FINISH	IMAGE
PE01	ADVENTURE WALKWAY SUPPLIER: STUDIO2 CONTACT: JAIMIE SERGEANT	TO BE DETERMINED DURING DOCUMENTATION STAGE	
PE02	PLAY MONSTER SCULPTURE ARTIST: TBC CONTACT: TBC	TO BE DETERMINED DURING DOCUMENTATION STAGE	TO BE DETERMINED DURING DOCUMENTATION STAGE
PE03	WATER PUMP TO SANDPIT SUPPLIER: MODUPLAY PRODUCT: MOUNTAIN STREAM	4110 x 2100 x 390-1350	
PE04	FOSSIL EXCAVATION SUPPLIER: ART DINOUEU PRODUCT: DIPROTODON FOSSIL SANDPIT INSERT	2500 x 2150 x 300	
PE05	ACCESSIBLE FOSSIL DIG TABLE SUPPLIER: ART DINOUEU PRODUCT: VELOCIRAPTOR FOSSIL SANDPIT	2500 x 2150 x 300	
PE06	LOG BALANCING BEAMS AND STEPPERS SUPPLIER: MODUPLAY PRODUCTS: BUSHWOOD BALANCE TRAIL 1, 5 AND 8	SUSTAINABLY SOURCED AUSTRALIAN TIMBER - ROT AND TERMITE PROOF TRAIL 1: MAX FALL HEIGHT 590mm TRAIL 5: MAX FALL HEIGHT 650mm TRAIL 9: MAX FALL HEIGHT 600mm BALANCE COMBINATIONS CAN BE CUSTOMISED TO FIT DESIGN	
PE07	STEEL NEST CAVES SUPPLIER: STUDIO2 CONTACT: JAIMIE SERGEANT	TO BE DETERMINED DURING DOCUMENTATION STAGE	

PE08	8 BAY SWING SUPPLIER: MODUPLAY PRODUCT: BUSHWOOD COMBO 3 SEATER NEST SWING (MODIFIED - 2 X CAPACITY)	1 nest swing [XSWA-3010] 2 inclusive boat seats [XSWA-0004] 1 Junior inclusive seat [XSWA-2005] 1 Senior inclusive seat [XSWA-2006] 2 Swings rigid seat [XSWA-2001]	
PE09	ACCESSIBLE TRAMPOLINE SUPPLIER: PLAYSPACE CREATIONS PRODUCT: AIRJUMPERS WHEELY	5300 x 5700	
PE10	XYLOPHONE SUPPLIER: MODUPLAY PRODUCT: BUSHWOOD XYLOPHONE	660 X 1100 X 995	
PE11	DRUM SUPPLIER: MODUPLAY PRODUCT: BUSHWOOD DRUM	760 X 1070 X 790	
PE12	3m A-FRAME CLIMBER SUPPLIER: STRABE PRODUCT: OBSTACLE COURSE ROPE WALL	2200 X 6349 X 3000	
PE13	NET SEESAW SUPPLIER: PLAYGROUND CENTRE PRODUCT: NETSEESAW	4000 X 800. LEVEL HEIGHT 500MM HIGH. TIRES 210MM ABOVE GROUND. POWDERCOAT DARK GREEN.	
PE14	SPINNING ROPE CLIMBER SUPPLIER: MODUPLAY PRODUCT: WHIRLY ROPE	1945 H X 1485 DIAMETER	
PE15	DEN MAKING WIG WAM SUPPLIER: TBC CONTACT: TBC	TO BE DETERMINED DURING DOCUMENTATION STAGE	
PE16	PLAY BRIDGE WITH BELLS CONTRACTOR: TBC	TO BE DETERMINED DURING DOCUMENTATION STAGE	

We have partnered with Leanne Watson, a local Darug artist, educator and illustrator to develop a suite of interpretive elements across the playground

KEY	
	Boundary fence 1.2m high
	Drainage path
ART / INTERPRETIVE ELEMENTS	
	Indigenous artwork wrap to hanging places building
	Indigenous artwork graphics integrated into: <ul style="list-style-type: none">- G1 Walkway balustrade- G2 Footpath footprints- G3 Main entry sign- G4 Nests
	Indigenous language opportunity <ul style="list-style-type: none">- L1 Welcome message on entry sign- L2 Meeting place- L3 Communications boards- L4 Megafauna- L5 Plants- L6 Tools
	Indigenous tool sensory element
	'Bara' Eel Darug creation story play sculpture
	Small metal plaques to find with Megafauna name (aboriginal / common / latin)outline of animal, outline of human, QR code link to NSW museum fact sheet.



MEGAFAUNA: ARTWORK RELATING BACK TO THEME OF AUSTRALIAN MEGAFAUNA



Megafauna footprints through site



Depictions of megafauna



Megafauna play

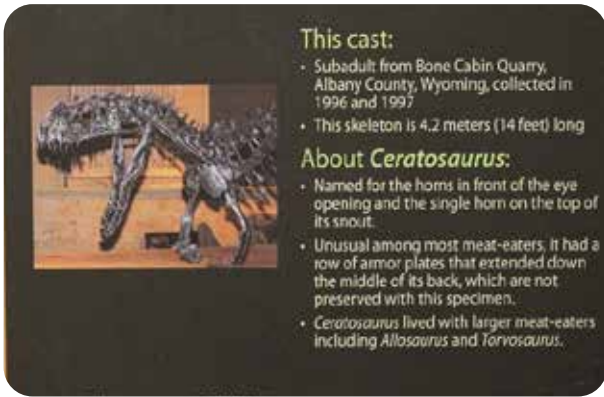

Megafauna information

CONNECTION TO COUNTRY: ARTWORK WHICH COMMUNICATES THE INDIGENOUS DARUG PEOPLE



Grinding grooves



First nation people



The Darug creator, The Bara (eel)



First nation footprints



Tools

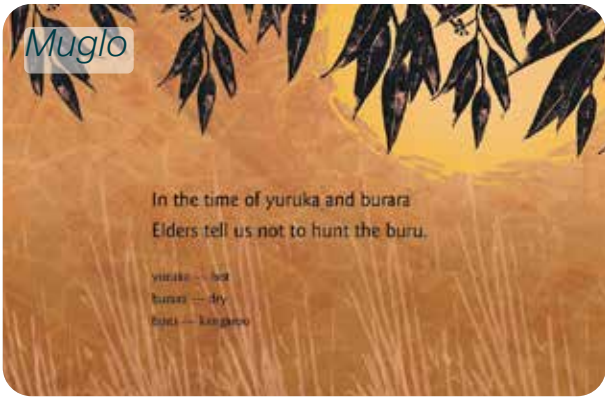

Language



Plants

KEY

- Boundary fence 1.2m high
- Drainage path

SEATING AND FURNITURE

- Rubbish Bin
- Accessible bubbler
- B1 Backless bench with armrests
- B2 Bench with back and armrests
- T1 Existing picnic table (Metal)
- T2 Existing picnic table (Wood/moveable)
- T3 Accessible picnic table
- SB Sandstone blocks
- BO Sandstone boulders within planting
- BE Sandstone boulder edge to bark mulch

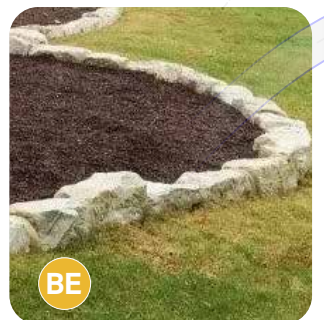

FENCING AND GATES

- BOUNDARY FENCE: 1.2m high. 100x100 hardwood posts, 125x38 top rail, black plastic coated chain mesh.
- G

ENTRY GATE: 1.8m wide gate with wheelchair accessible lock

SIGNAGE

- S1

PLAYGROUND ENTRY SIGN. To be a bold statement with the playground name that references the materiality of the walkway and includes graphic elements referenced from the playground artwork. Set into feature planting with boulders
- S2

WELCOME SIGN AND MAIN COMMUNICATIONS BOARD:
Welcome message (Darug + English + others) with map of park and explanation of theme and key points of interest. Sponsors and contributors to be displayed. Play communications board. (These 2 signs may be combined)
- S3

COMMUNICATIONS BOARDS: Located at key spaces to facilitate communication of non verbal park users. Darug language to be integrated.

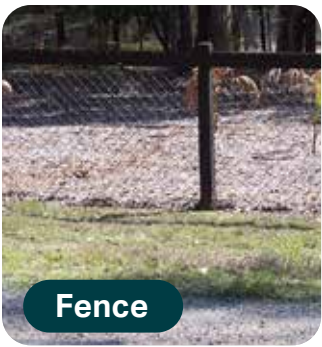

PLANTING PALETTE: LOW MAINTENANCE, TEXTURAL CUMBERLAND PLAIN SPECIES UP TO 1M HIGH.



Arthropodium milleflorum
Floral / Sensory



Dianella revoluta
Floral / Textural



Dichelachne micrantha
Soft / Textural / Sensory



Lepidosperma laterale
Spikey / Textural



Lomandra multiflora
Floral / Textural



Lissanthe strigosa
Floral / Textural



Panicum simile
Soft / Textural / Sensory



Microlaena stipoides
Soft / Textural / Sensory



Pratia purpurascens
Floral / Low planting



Tricoryne elatior
Floral / Low planting



Themeda australis
Soft / Textural / Sensory



Wahlenbergia gracilis
Floral / Low planting

PROPOSED TREES:



Eucalyptus maculata



Eucalyptus moluccana



Eucalyptus tereticornis